

## 6. Exploded View & Parts List

### 6-1 CK14F1T5X/XEH

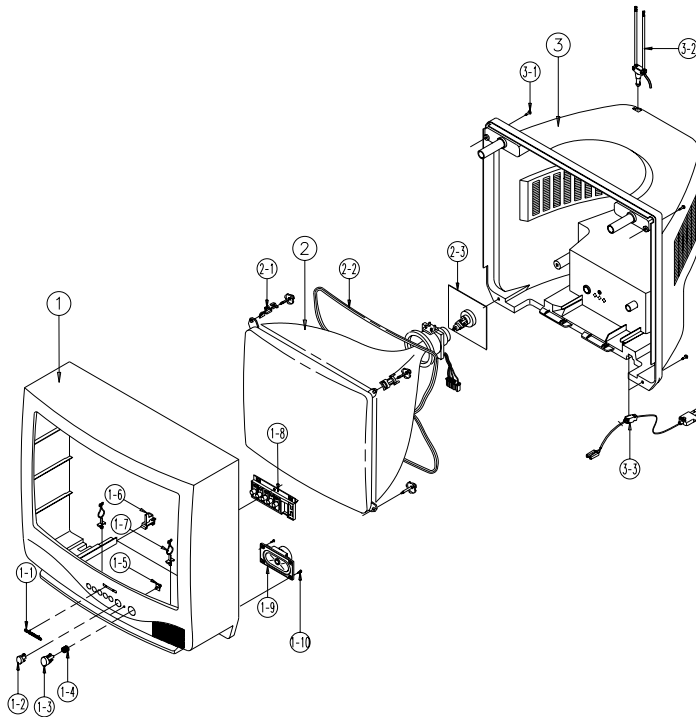

| No   | Code No     | Description        | Specification                  | Q'ty | Remark |
|------|-------------|--------------------|--------------------------------|------|--------|
| 1    | HA91-100019 | ASSY-CABINET,FRONT | 331F                           | 1    | LOCAL  |
|      | HA64-300051 | CABINET-FRONT      | -,331F,P94.908,HIPS,HB,BLK     | 1    | LOCAL  |
| 1-1  | AA64-70009F | BADGE-BRAND        | -,AL,-,L40,SILVER,R800 SS 22,- | 1    |        |
| 1-2  | AA64-40450A | WINDOW-RMC         | -,501F,-,ABS,HB,LG-41338,-     | 1    |        |
| 1-3  | HA64-10704C | KNOB-POWER         | -,331F,-,ABS,HB,BLK            | 1    | LOCAL  |
| 1-4  | AA61-60003T | SPRING-CS          | -,SUS304,0.5,OD7,H13.5,N5,-,-, | 1    |        |
| 1-5  | AA64-40451A | INDICATOR-LED      | -,331F,-,ABS,HB,-,-            | 1    |        |
| 1-6  | AA61-40007A | STOPPER-PCB        | 5038.5368,ABS HB,NTR,-,-,-     | 1    |        |
| 1-7  | AA65-30105A | CLAMP-WIRE         | NYLON 66,V2,NTR,15MM,ALL MODEL | 1    |        |
| 1-8  | HA64-10705A | KNOB-CONTROL       | -,501F,-,ABS,HB,BLK            | 1    | LOCAL  |
| 1-9  | 3001-000275 | SPEAKER            | 2.5W,16ohm,90dB,105Hz          | 1    |        |
| 1-10 | 6002-000514 | SCREW-TAPPING      | RH,+,2,M4,L15,ZPC(BLK),SWRCH18 | 2    |        |
| 2    | AA03-10023X | CRT-COLOR          | -,A34EAC01X06,+380mG,14,90DEG  | 1    |        |
| 2-1  | AA65-30106A | CLAMP-D,COIL       | NYLON 66,V2,NTR,-,14 INCH,-    | 2    |        |
| 2-2  | AA27-20003U | COIL-DEGAUSSING    | -,14,16.4ohm,75T,890mm,D       | 1    |        |
| 2-3  | 3704-001089 | SOCKET-CRT         | 7P,22.5PI,12PI,SN,-            | 1    |        |
| 3    | HA64-300053 | CABINET-BACK       | DP,331F,HIPS,V2,BLK,-          | 1    | LOCAL  |
| 3-1  | 6002-000514 | SCREW-TAPPING      | RH,+,2,M4,L15,ZPC(BLK),SWRCH18 | 4    |        |
| 3-2  | AA42-10001V | ANT-ROD            | -,3S,620mm,BRN,UL/CSA          | 1    |        |
| 3-3  | AA61-20284A | HOLDER             | -,P-CORD,PP,VO,BLK,KE-002      | 1    |        |