

JA 6110 (SPAIN)

POWER AMPLIFIER

PRODUCT CODE NO.

129-252-05 (Black)

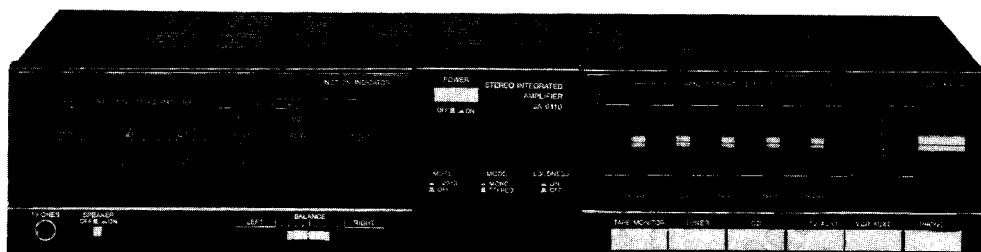
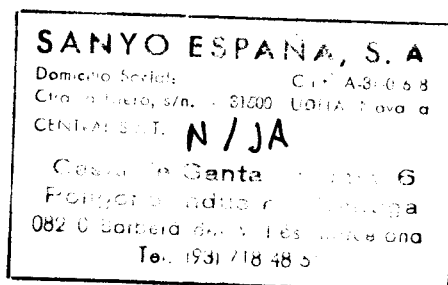

SPECIFICATIONS

Continuous output power	35 W x 2 (at 8 ohms, 0.9% distortion)
Input sensitivity and impedance	
PHONO	2.5 mV/47 kohms
CD/TV/AUX1/VCR/AUX2	150 mV/47 kohms
Frequency response	20 Hz – 35 kHz (CD)
Graphic equalizer	±10 dB (63/250/1000/4000/16000 Hz)
Loudness control response	
(Vol. –30 dB)	+8 dB/+4 dB (100 Hz/10 kHz)
Signal to noise ratio	95 dB (CD)
Power requirements	AC: 220 V, 50 Hz
Power consumption	190 W
Dimensions (W x D x H)	Approx. 420 x 200 x 85 mm (16-1/2" x 7-7/8" x 3-3/8")
Weight	Approx. 4.2 kg (9 lbs. 4 ozs.)

Specifications subject to change without notice.

REFERENCE No. WM-20778

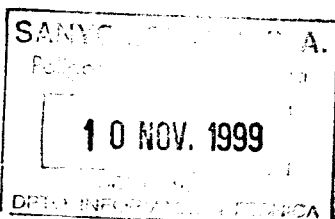

CABINET & CHASSIS EXPLODED VIEW

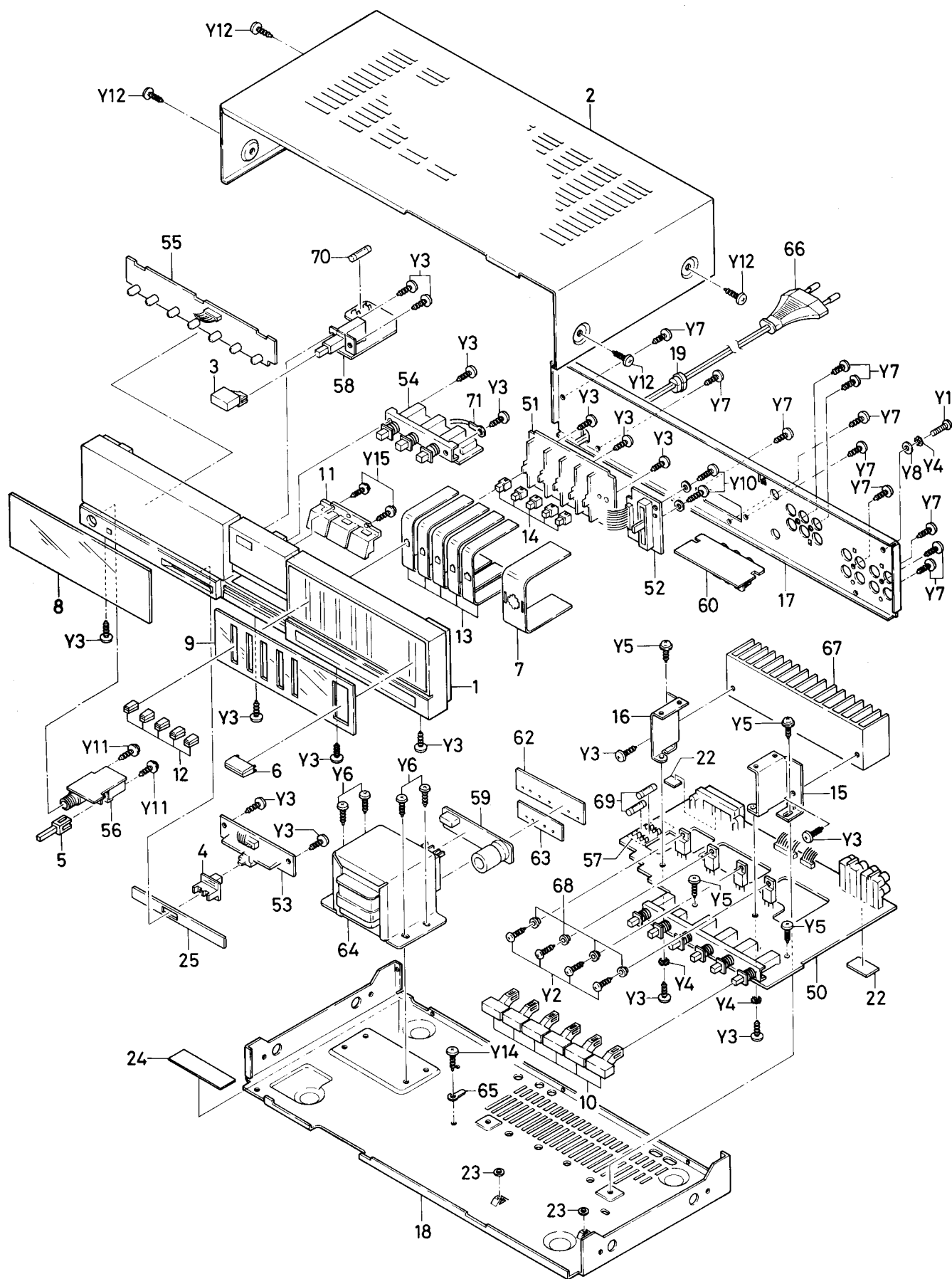

PARTS LIST

PRODUCT SAFETY NOTICE

Each precaution in this manual should be followed during servicing. Components identified with the IEC symbol Δ in the parts list and the schematic diagram designate components in which safety can be of special significance. When replacing a component identified with Δ , use only the replacement parts designated, or parts with the same ratings of resistance, wattage or voltage that are designated in the parts list in this manual.

Leakage-current or resistance measurements must be made to determine that exposed parts are acceptably insulated from the supply circuit before returning the product to the customer.

PACKING & ACCESSORIES

Ref. No.	Part No.	Description
	141-6-409T-38113	INST MANUAL
	141-6-133T-71120	INNER CORR CASE
	141-6-144T-93000	FOAM PLASTIC CASE
	141-6-235T-35601	INNER POLYE LAMINA COVER, 350X600
or	141-6-235T-35605	INNER POLYE LAMINA COVER

CABINET & CHASSIS

Ref. No.	Part No.	Description
1	141-0-122T-65901	FRONT PANEL ASSY
2	141-0-111T-58207	CABINET ASSY
3	141-2-160T-60303	PUSH BUTTON, POWER SW
4	141-2-164T-41801	SLIDE KNOB, BALANCE
5	141-2-160T-60801	PUSH BUTTON, SPEAKER SW
6	141-2-164T-47900	SLIDE KNOB, MAIN VOLUME
7	141-2-241T-30400	VEIL, MAIN VOLUME
8	141-2-131T-58300	CLEAR WINDOW, FUNCTION
9	141-2-131T-58400	CLEAR WINDOW, VEIL
10	141-2-160T-81600	PUSH BUTTON, FUNCTION
11	141-2-160T-81700	PUSH BUTTON, MODE/MUTE/LOUD
12	141-2-164T-40601	SLIDE KNOB, EQUALIZER
13	141-2-241T-30900	VEIL, EQUALIZER
14	141-2-253T-45300	JOINT, EQUALIZER
15	141-2-310T-61702	BRACKET, HEAT SINK, RIGHT
16	141-2-310T-61802	BRACKET, HEAT SINK, LEFT
17	141-2-126T-55624	BACK LID
18	141-0-125T-31909	BOTTOM LID ASSY
19	141-2-464T-14400	FIXER, AC POWER CORD
20	141-2-210T-71200	BRACKET, CONNECTOR, LARGE
21	141-2-210T-71300	BRACKET, CONNECTOR, SMALL
22	141-2-247T-79400	SHEET, 9X7X0.5
23	141-2-453T-09600	WASHER, FIBER, 3X9X0.35
24	141-2-247T-80400	SHEET, 50X26X0.5T
25	141-2-247T-69000	SHEET, BALANCE

FIXING PARTS

Ref. No.	Part No.	Description
Y1	412 003 2804	SPECIAL SCREW
Y2	411 001 8900	SCR BIN 3X8
Y3	411 021 6405	SCR S-TPG BIN 3X8
Y4	411 008 0402	WASHER OUT TW 3
Y5	411 020 9803	SCR S-TPG BRZ + FLG 3X6
Y6	411 001 4209	SCR S-TPG BIN 4X8
Y7	412 004 3107	SPECIAL SCREW
Y8	411 105 9605	WASHER Z 3X10X1
Y10	411 021 3503	SCR S-TPG BIN 3X10
Y11	411 020 9902	SCR S-TPG BRZ + FLG 3X8
Y12	411 021 6603	SCR S-TPG BIN 3X8
Y13	411 027 3101	SCR S-TPG BIN 3X8
Y14	411 001 1901	SCR S-TPG BIN 3X6
Y15	411 024 3807	SCR S-TPG PAN + FLG 2X8

ELECTRICAL PARTS

Ref. No.	Part No.	Description
62	Δ 4-290T-17000	P.C BOARD, P.T. PRIMARY
63	4-290T-27000	P.C BOARD, P.T. COVER
64	Δ 4-320T-20771	P.T
65	141-2-472T-12600	LUG, MODE SW PCB
66	Δ 4-243T-84973	AC POWER CORD
67	141-2-368T-26206	HEAT SINK
68	141-2-243T-09800	BASE
69	Δ 4-234T-10589	FUSE T2.5A 250V, SEMKO
70	Δ 4-234T-10584	FUSE T1.0A 250V, SEMKO
71	141-2-472T-00401	LUG, FTZ
	4-240T-47672	SOCKET, 2P (D.M.)
	4-240T-47673	SOCKET, 3P (D.M.)
	4-240T-83575	SOCKET, 5P
	4-240T-83577	SOCKET, 7P
	4-267T-17175	SOCKET, 5P
	4-267T-17177	SOCKET, 7P
	4-267T-17179	SOCKET, 9P

MAIN PCB ASSY

Ref. No.	Part No.	Description
50	141-4-290T-00101	P.C BOARD ASSY, MAIN
	4-240T-50471	SOCKET, RCA 4P
	4-267T-39471	SOCKET, W/LEAD, 5P, TO TUNER
	4-267T-39571	SOCKET, W/LEAD, 9P, TO DECK
	4-267T-19800	SOCKET, SYNCHRO REC
	4-237T-09990	TERMINAL BOARD
S2~7	4-248T-27800	PUSH SWITCH, FUNCTION
SVR703	4-222T-73595	V.R, 150B
SVR803	4-222T-73595	V.R, 150B
IC701	409 018 4503	IC LA6458DS
or	409 036 7005	IC M5218P
or	409 039 7705	IC NJM4558DD
Q776	405 001 7803	TR 2SA1016-G
or	405 002 0605	TR 2SA1038-S
Q777	405 001 7803	TR 2SA1016-G
or	405 002 0605	TR 2SA1038-S
Q778	405 001 7803	TR 2SA1016-G
Q779	405 002 0605	TR 2SA1038-S
or	405 014 0709	TR 2SC2362-G
Q780	405 014 2802	TR 2SC2389-S
or	405 023 8307	TR 2SD438-E-MP
Q781	405 007 5100	TR 2SC389-Y
Q782	405 012 3504	TR 2SC1827-Y
Q783	405 005 3900	TR 2SA769-Y
Q784	405 001 7803	TR 2SA1016-G
Q876	405 002 0605	TR 2SA1038-S
or	405 001 7803	TR 2SA1016-G
Q877	405 001 7803	TR 2SA1016-G
or	405 002 0605	TR 2SA1038-S
Q878	405 002 0605	TR 2SA1038-S
Q879	405 001 7803	TR 2SA1016-G
or	405 002 0605	TR 2SA1038-S
Q880	405 014 0709	TR 2SC2362-G
or	405 014 2802	TR 2SC2389-S
Q881	405 023 8307	TR 2SD438-E-MP
Q882	405 007 5100	TR 2SB560-E-MP
Q883	405 012 3504	TR 2SC1827-Y
Q884	405 005 3900	TR 2SA769-Y
Q901	405 023 5306	TR 2SD400-F-MP

PARTS LIST

Ref. No.	Part No.	Description
Q902	405 007 3106	TR 2SB544-F-MP
D775	407 007 9904	DIODE GMA01
D776	407 007 9904	DIODE GMA01
D777	407 007 9904	DIODE GMA01
D778	407 005 4505	DIODE DS442X
D779	407 005 4505	DIODE DS442X
D780	407 005 4505	DIODE DS442X
D875	407 007 9904	DIODE GMA01
D878	407 005 4505	DIODE DS442X
D879	407 005 4505	DIODE DS442X
D880	407 005 4505	DIODE DS442X
D901	△ 407 088 6403	DIODE GP15-D-L
D902	△ 407 088 6403	DIODE GP15-D-L
D903	△ 407 088 6403	DIODE GP15-D-L
D904	△ 407 088 6403	DIODE GP15-D-L
D909	407 053 3703	ZENER DIODE MTZ15B
D910	407 053 3703	ZENER DIODE MTZ15B
D911	407 005 4505	DIODE DS442X
C701	403 047 0109	ELECT 47U M 25V
C702	403 040 1905	ELECT 22U M 10V
C703	403 033 9406	CERAMIC 820P K 50V
C704	403 069 0705	CERAMIC 1000P K 50V
C705	403 003 0600	CERAMIC 0.018U K 25V
C706	403 003 9405	CERAMIC 4700P K 25V
C707	403 106 1603	NP-ELECT 1U Q 50V
C712	403 024 8203	CERAMIC 390P K 50V
C758	403 057 2803	POLYESTER 0.1U K 50V
C759	403 057 2803	POLYESTER 0.1U K 50V
C776	403 026 8201	CERAMIC 470P K 50V
C777	403 049 0305	ELECT 1U M 50V
C779	403 041 2307	ELECT 47U M 10V
C780	403 039 6904	ELECT 100U M 10V
C781	403 031 0306	CERAMIC 68P K 50V
C784	403 049 6307	ELECT 100U M 50V
C786	403 069 8404	CERAMIC 0.01U Z 50V
C801	403 047 0109	ELECT 47U M 25V
C802	403 040 1905	ELECT 22U M 10V
C803	403 033 9406	CERAMIC 820P K 50V
C804	403 069 0705	CERAMIC 1000P K 50V
C805	403 003 0600	CERAMIC 0.018U K 25V
C806	403 003 9405	CERAMIC 4700P K 25V
C807	403 106 1603	NP-ELECT 1U Q 50V
C812	403 024 8203	CERAMIC 390P K 50V
C858	403 057 2803	POLYESTER 0.1U K 50V
C859	403 057 2803	POLYESTER 0.1U K 50V
C876	403 026 8201	CERAMIC 470P K 50V
C877	403 049 0305	ELECT 1U M 50V
C879	403 041 2307	ELECT 47U M 10V
C880	403 039 6904	ELECT 100U M 10V
C881	403 031 0306	CERAMIC 68P K 50V
C884	403 049 6307	ELECT 100U M 50V
C886	403 069 8404	CERAMIC 0.01U Z 50V
C900	403 069 8404	CERAMIC 0.01U Z 50V
C901	403 101 4401	ELECT 3300U M 50V
C902	403 101 4401	ELECT 3300U M 50V
C903	403 047 3407	ELECT 47U M 25V
C904	403 047 3407	ELECT 47U M 25V
C907	403 042 2702	ELECT 100U M 16V
C908	403 042 2702	ELECT 100U M 16V
C909	403 069 8404	CERAMIC 0.01U Z 50V
C911	403 002 4203	CERAMIC 0.1U M 25V
C956	403 069 8404	CERAMIC 0.01U Z 50V
C957	403 069 8404	CERAMIC 0.01U Z 50V
R701	401 025 1605	CARBON 1.5K JA 1/6W
R703	401 027 0309	CARBON 47K JA 1/6W
R704	401 026 3905	CARBON 330 JA 1/6W
R705	401 026 1604	CARBON 270K JA 1/6W
R706	401 025 1902	CARBON 15K JA 1/6W
R708	401 027 2303	CARBON 560 JA 1/6W
R712	401 027 0309	CARBON 47K JA 1/6W
R751	401 024 7004	CARBON 1K JA 1/6W
R752	401 024 7707	CARBON 100K JA 1/6W
R756	401 025 8208	CARBON 22K JA 1/6W

Ref. No.	Part No.	Description
R762	401 010 5601	CARBON 5.6 JB 1/2W
R777	401 027 5908	CARBON 68K JA 1/6W
R778	401 025 1605	CARBON 1.5K JA 1/6W
R779	401 027 2303	CARBON 560 JA 1/6W
R780	401 024 7004	CARBON 1K JA 1/6W
R781	401 026 9600	CARBON 470 JA 1/6W
R782	401 022 4104	CARBON 68K JA 1/4W
R784	401 025 1308	CARBON 150 JA 1/6W
R785	401 023 0303	CARBON 82 JB 1/4W
R786	401 026 9303	CARBON 47 JA 1/6W
R787	401 020 0405	CARBON 470 JB 1/4W
R788	401 057 5206	OXIDE-MT 0.47 JA 1W
R789	401 057 5206	OXIDE-MT 0.47 JA 1W
R791	401 025 8208	CARBON 22K JA 1/6W
R801	401 025 1605	CARBON 1.5K JA 1/6W
R803	401 027 0309	CARBON 47K JA 1/6W
R804	401 026 3905	CARBON 330 JA 1/6W
R805	401 026 1604	CARBON 270K JA 1/6W
R806	401 025 1902	CARBON 15K JA 1/6W
R808	401 027 2303	CARBON 560 JA 1/6W
R812	401 027 0309	CARBON 47K JA 1/6W
R851	401 024 7004	CARBON 1K JA 1/6W
R852	401 010 5601	CARBON 100K JA 1/6W
R877	401 027 5908	CARBON 68K JA 1/6W
R878	401 025 1605	CARBON 1.5K JA 1/6W
R879	401 027 2303	CARBON 560 JA 1/6W
R880	401 024 7004	CARBON 1K JA 1/6W
R881	401 026 9600	CARBON 470 JA 1/6W
R882	401 022 4104	CARBON 68K JA 1/4W
R884	401 025 1308	CARBON 150 JA 1/6W
R885	401 023 0303	CARBON 82 JB 1/4W
R886	401 026 9303	CARBON 47 JA 1/6W
R887	401 020 0405	CARBON 470 JB 1/4W
R888	401 057 5206	OXIDE-MT 0.47 JA 1W
R889	401 057 5206	OXIDE-MT 0.47 JA 1W
R901	401 062 1200	OXIDE-MT 470 JA 1W
R902	401 062 1200	OXIDE-MT 470 JA 1W
R903	401 026 9907	CARBON 4.7K JA 1/6W
R904	401 026 9907	CARBON 4.7K JA 1/6W
R907	401 022 1905	CARBON 680 JA 1/4W
R909	401 013 5301	CARBON 1.2K JA 1/4W
R920	401 024 7400	CARBON 10K JA 1/6W
R921	401 024 7400	CARBON 10K JA 1/6W

GRAPHIC EQUALIZER PCB ASSY

Ref. No.	Part No.	Description
51	141-4-290T-00200	P C BOARD ASSY,
VR751,851	4-220T-42000	GRAPHIC EQUALIZER
VR752,852	4-220T-42000	V R, 250K, 63HZ
VR753,853	4-220T-42000	V R, 250K, 250HZ
VR754,854	4-220T-42000	V R, 250K, 1KHZ
VR755,855	4-220T-42000	V R, 250K, 4KHZ
IC702	409 018 4909	V R, 250K, 16KHZ
Q721	405 019 3705	IC LA6458S
Q722	405 019 3705	TR 2SC536-G-AUD-SPA
Q723	405 019 3705	TR 2SC536-G-AUD-SPA
Q724	405 019 3705	TR 2SC536-G-AUD-SPA
Q725	405 019 3705	TR 2SC536-G-AUD-SPA
Q821	405 019 3705	TR 2SC536-G-AUD-SPA
Q822	405 019 3705	TR 2SC536-G-AUD-SPA
Q823	405 019 3705	TR 2SC536-G-AUD-SPA
Q824	405 019 3705	TR 2SC536-G-AUD-SPA
Q825	405 019 3705	TR 2SC536-G-AUD-SPA
C713	403 047 0109	ELECT 4.7U M 25V
C714	403 047 0109	ELECT 4.7U M 25V
C715	403 009 8105	CERAMIC 100P K 50V
C721	403 050 0004	ELECT 2.2U M 50V
C722	403 067 5603	MT-COMPO 0.1U J 50V
C723	403 048 6506	ELECT 0.47U M 50V

PARTS LIST

BALANCE PCB ASSY

Ref. No.	Part No.	Description
53 VR707	141-4-290T-00400 4-220T-42100	P.C BOARD ASSY, BALANCE V.R, 250K, BALANCE

MODE/MUTE/LOUD SWITCH PCB ASSY

Ref. No.	Part No.	Description
54	141-4-290T-00500	P.C BOARD ASSY, MODE/MUTE/LOUD SWITCH
S8~10	4-248T-27700	PUSH SWITCH, MODE/MUTE/LOUD
C741	403 031 2805	CERAMIC 680P K 50V
C742	403 002 3602	CERAMIC 0.1U K 25V
C841	403 031 2805	CERAMIC 680P K 50V
C842	403 002 3602	CERAMIC 0.1U K 25V
R741	401 025 7805	CARBON 22K JA 1/6W
R742	401 026 4605	CARBON 33K JA 1/6W
R743	401 027 0309	CARBON 47K JA 1/6W
R744	401 027 2600	CARBON 56K JA 1/6W
R745	401 027 2600	CARBON 22K JA 1/6W
R746	401 027 2600	CARBON 56K JA 1/6W
R841	401 025 7805	CARBON 22K JA 1/6W
R842	401 026 4605	CARBON 33K JA 1/6W
R843	401 027 0309	CARBON 47K JA 1/6W
R844	401 027 2600	CARBON 56K JA 1/6W
R845	401 025 7805	CARBON 22K JA 1/6W
R846	401 027 2600	CARBON 56K JA 1/6W

LED PCB ASSY

Ref. No.	Part No.	Description
55	141-4-290T-00600	P.C BOARD ASSY, LED
D1	407 039 5905	LED SLP-738F-51-B GR
D2	407 039 5905	LED SLP-738F-51-B GR
D3	407 039 5905	LED SLP-738F-51-B GR
D4	407 039 5905	LED SLP-738F-51-B GR
D5	407 039 5905	LED SLP-738F-51-B GR
D6	407 036 9203	LED SLP-138C-51-B RE

SPEAKER SWITCH PCB ASSY

Ref. No.	Part No.	Description
56	141-4-290T-00701	P.C BOARD ASSY, SPEAKER SWITCH
S11	4-240T-63071	SOCKET, HEADPHONE
R763	4-248T-27900	PUSH SWITCH, SPEAKER
R863	401 009 5902	CARBON 330 JB 1/2W
	401 009 5902	CARBON 330 JB 1/2W

SPEAKER FUSE PCB ASSY

Ref. No.	Part No.	Description
57	141-4-290T-00871 141-2-381T-04202	P.C BOARD ASSY, SPEAKER FUSE BRACKET FUSE

POWER SWITCH PCB ASSY

Ref. No.	Part No.	Description
58	141-4-290T-00971 141-2-381T-04202 141-2-382T-18900	P.C BOARD ASSY, POWER SWITCH BRACKET FUSE TERMINAL
S1	Δ 4-238T-70380	SWITCH, POWER
C906	Δ 404 000 1607	CERAMIC 103P P 125V
or	Δ 404 033 3302	CERAMIC 0.01U M -

Ref. No.	Part No.	Description
C724	403 003 2802	CERAMIC 0.022U K 25V
C725	403 067 5900	MT-COMPO 0.12U J 50V
C726	403 004 3303	CERAMIC 6800P K 25V
C727	403 003 6701	CERAMIC 0.033U K 25V
C728	403 002 7204	CERAMIC 1500P K 25V
C729	403 004 5505	CERAMIC 8200P K 25V
C730	403 023 5807	CERAMIC 330P K 50V
C813	403 047 0109	ELECT 4.7U M 25V
C814	403 047 0109	ELECT 4.7U M 25V
C815	403 009 8105	CERAMIC 100P K 50V
C821	403 050 0004	ELECT 2.2U M 50V
C822	403 067 5603	MT-COMPO 0.1U J 50V
C823	403 048 6506	ELECT 0.47U M 50V
C824	403 003 2802	CERAMIC 0.022U K 25V
C825	403 067 5900	MT-COMPO 0.12U J 50V
C826	403 004 3303	CERAMIC 6800P K 25V
C827	403 003 6701	CERAMIC 0.033U K 25V
C828	403 002 7204	CERAMIC 1500P K 25V
C829	403 024 5505	CERAMIC 8200P K 25V
C830	403 023 5807	CERAMIC 330P K 50V
R714	401 025 7805	CARBON 22K JA 1/6W
R715	401 025 7805	CARBON 22K JA 1/6W
R721	401 026 6609	CARBON 390 JA 1/6W
R722	401 027 5502	CARBON 68K JA 1/6W
R723	401 027 2303	CARBON 560 JA 1/6W
R724	401 027 5908	CARBON 68K JA 1/6W
R725	401 026 6609	CARBON 390 JA 1/6W
R726	401 027 5502	CARBON 68K JA 1/6W
R727	401 027 2303	CARBON 560 JA 1/6W
R728	401 027 5908	CARBON 68K JA 1/6W
R729	401 026 6609	CARBON 390 JA 1/6W
R730	401 027 5502	CARBON 68K JA 1/6W
R731	401 027 2303	CARBON 560 JA 1/6W
R732	401 027 5908	CARBON 68K JA 1/6W
R733	401 026 6609	CARBON 390 JA 1/6W
R734	401 027 5502	CARBON 68K JA 1/6W
R735	401 027 2303	CARBON 560 JA 1/6W
R736	401 027 5908	CARBON 68K JA 1/6W
R737	401 026 6609	CARBON 390 JA 1/6W
R738	401 027 5502	CARBON 68K JA 1/6W
R739	401 027 2303	CARBON 560 JA 1/6W
R740	401 027 5908	CARBON 68K JA 1/6W
R814	401 025 7805	CARBON 22K JA 1/6W
R815	401 025 7805	CARBON 22K JA 1/6W
R821	401 026 6609	CARBON 390 JA 1/6W
R822	401 027 5502	CARBON 68K JA 1/6W
R823	401 027 2303	CARBON 560 JA 1/6W
R824	401 027 5908	CARBON 68K JA 1/6W
R825	401 026 6609	CARBON 390 JA 1/6W
R826	401 027 5502	CARBON 68K JA 1/6W
R827	401 027 2303	CARBON 560 JA 1/6W
R828	401 027 5908	CARBON 68K JA 1/6W
R829	401 026 6609	CARBON 390 JA 1/6W
R830	401 027 5502	CARBON 68K JA 1/6W
R831	401 027 2303	CARBON 560 JA 1/6W
R832	401 027 5908	CARBON 68K JA 1/6W
R833	401 026 6609	CARBON 390 JA 1/6W
R834	401 027 5502	CARBON 68K JA 1/6W
R835	401 027 2303	CARBON 560 JA 1/6W
R836	401 027 5908	CARBON 68K JA 1/6W
R837	401 026 6609	CARBON 390 JA 1/6W
R838	401 027 5502	CARBON 68K JA 1/6W
R839	401 027 2303	CARBON 560 JA 1/6W
R840	401 027 5908	CARBON 68K JA 1/6W

VOLUME PCB ASSY

Ref. No.	Part No.	Description
52 VR706,806	141-4-290T-00300 4-220T-27500	P.C BOARD ASSY, VOLUME V.R, 100K, MAIN VOLUME

PARTS LIST

P.T. SECONDARY PCB ASSY

Ref. No.	Part No.	Description
59	141-4-290T-01000	P.C BOARD ASSY, P.T. SECONDARY
D905	Δ 407 004 9105	DIODE DSF10C
D906	Δ 407 004 9105	DIODE DSF10C
D907	Δ 407 004 9105	DIODE DSF10C
D908	Δ 407 004 9105	DIODE DSF10C
C905	4-223T-18400	CAPACITOR
C912	403 057 0403	POLYESTER 0.01U K 50V
C913	403 057 0403	POLYESTER 0.01U K 50V
C958	403 067 5603	MT-COMPO 0.1U J 50V
R910	401 057 5206	OXIDE-MT 0.47 JA 1W

REGULATOR 1 PCB ASSY

Ref. No.	Part No.	Description
60	141-4-290T-01100	P.C BOARD ASSY, REGULATOR 1
IC902	409 001 7603	IC AN7812F
C951	403 049 0305	ELECT 1U M 50V
C952	403 041 9009	ELECT 10U M 16V

REGULATOR 2 PCB ASSY

Ref. No.	Part No.	Description
61	141-4-290T-01200	P.C BOARD ASSY, REGULATOR 2
IC903	409 001 7603	IC AN7812F
C953	403 049 0305	ELECT 1U M 50V
C954	403 041 9009	ELECT 10U M 16V

SCHEMATIC DIAGRAM

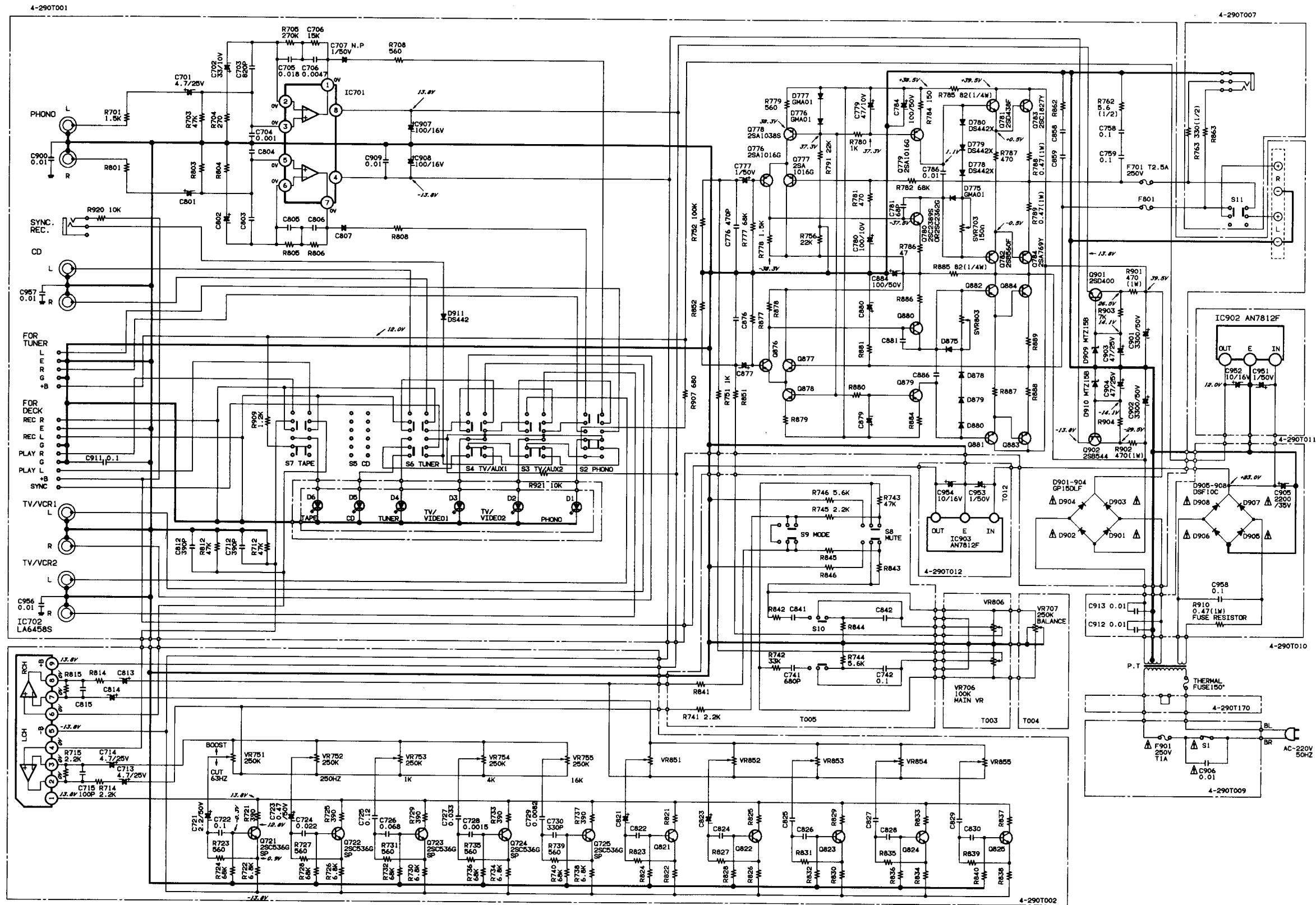

PRODUCT SAFETY NOTICE

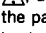
Each precaution in this manual should be followed during servicing. Components identified with the IEC symbol  in the parts list and the schematic diagram designate components in which safety can be of special significance. When replacing a component identified with , use only the replacement parts designated, or parts with the same ratings of resistance, wattage or voltage that are designated in the parts list in this manual. Leakage current or resistance measurements must be made to determine that exposed parts are acceptably insulated from the supply circuit before returning the product to the customer.

- S1.....POWER SW
- S2 - S7.....FUNCTION SW
- S9.....MODE SW
- S8.....AUDIO MUTE SW
- S10.....LOUDNESS SW
- S11.....SP SW

